

GLI-FCTA

Floating Curved Troffer A



Project: _____ Location: _____ Type: _____

Model Number: _____ Qty: _____ Notes: _____ Date: _____

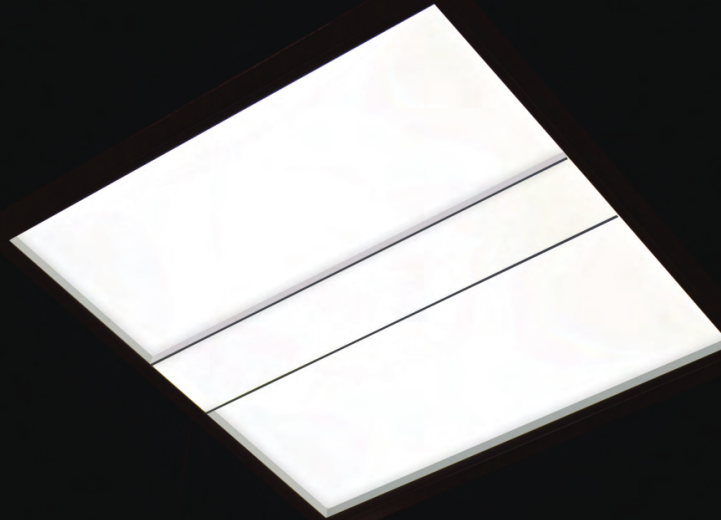

GLI-FCTA Floating Curved Troffer A is designed to deliver unprecedented uniformity and functionality, this floating curved troffer features a compact yet sturdy aluminium construction designed to blend into modern architectural spaces. Featuring a low profile form factor, it is ideal for buildings with a low plenum space and is suitable for all standard grid ceilings.

Lighting:

- High diffusion lens for comfortable light
- High CRI: Minimum 80 color rendering index
- Adjustable CCT of 3500K, 4000K, 5000K
- Back-lit technology for uniform and soft illumination

Installation:

- Recessed installation compatible with standard 2x2, 1x4, or 2x4 grid ceilings
- Low profile design ideal for low plenum spaces
- Compatible with various T-grid systems, including 9/16" Flat, 9/16" Slot, 15/16" Flat, and 15/16" Slot

Electrical:

- Wattage adjustable: 35W/30W/25W for 2x2' and 1x4, 50W/40W/30W for 2x4'
- Input voltage options: 110-277V or 110-347V
- High efficiency LEDs provide up to 110 lm/W
- Optional DLC version available with higher efficiency LEDs providing up to 125 lm/W
- Standard 1-10V dimming which continuously dims to 10%

Details:

- Compact yet sturdy aluminum construction with powder coated white finish
- Optional emergency LED driver for up to 120 minutes of backup lighting
- Suitable for commercial and institutional spaces including offices, classrooms, retail, and healthcare facilities

Certifications:

- cULus Listed
- DesignLights Consortium Qualified and classified for DLC standard/premium
- 5 years limited warranty
- Estimated lifespan of over 50,000 hours

Dimensions:

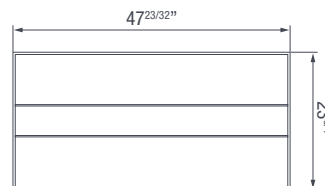
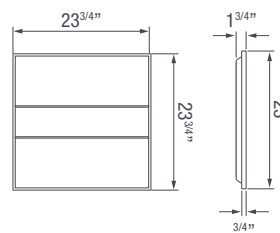

ORDERING GUIDE

SERIES	DIMENSIONS	DLC	VOLTAGE	CCT	CONTROL	BATTERY BACKUP
GLI-FCTA	22 - 2x2 ft 14' - 1x4 ft 24 - 2x4 ft	SD - Standard DLC PD - Premium DLC	V1 - 110-277V V2 - 110-347V	3SK² - 3 CCT	DM - 1-10V to 10% OS - Occupancy sensor DO - Daylight and Occupancy sensor	NB - No battery BB - 8W battery backup

Notes:

1. Not available with DLC Premium certification
2. Selectable CCTs (3000/3500/4000K)

SPECIFICATIONS

MODEL	LENGTH	WATTAGE	LM	LUMENS/FOOT	LM/W	CCT
GLI-FCTA-22-DS	2x2 ft	35/30/25W	3850/3300/2750LM	1925/1650/1375LM/ft	110LM/W	3000K
GLI-FCTA-14-DS	1x4 ft	35/30/25W	3850/3300/2750LM	963/825/688LM/ft	110LM/W	3000K
GLI-FCTA-24-DS	2x4 ft	50/40/30W	5500/4400/3300LM	1375/1100/825LM/ft	110LM/W	3000K
GLI-FCTA-22-PD	2x2 ft	35/30/25W	4375/3750/3125LM	2188/1875/1563LM/ft	125LM/W	3000K
GLI-FCTA-24-PD	2x4 ft	50/40/30W	6250/5000/3750LM	1563/1250/938LM/ft	125LM/W	3000K

All efficacy ratings are ±5% based on different CCTs and lighting distributions.

INSTALLATION

T-Grid Compatibility

Compatible with most 15/16" and 9/16" T-grid systems for commercial and institutional environments. The following are only some common examples for reference.

9/16" Flat



Suprafine® XL

9/16" Slot



Silhouette® 1/4" XL



Silhouette® 1/8" XL

9/16" Interlude



Interlude® XL



Sonata® XL

15/16" Flat

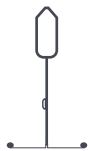

Prelude® XL



Clean Room

PHOTOMETRY

[↗ IES Files](#)

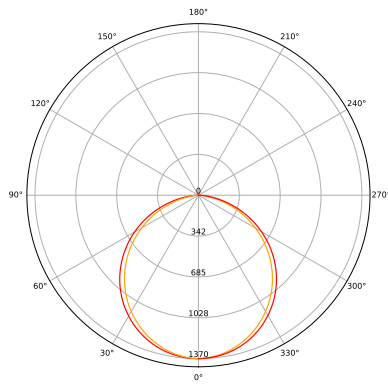

GLI-FCTA-14-SD-V1-3SK-XX-XX 3CCT@3500K		
ZONE	LUMENS	%
0-30	1,056	27.9%
0-40	1,724	45.5%
0-60	3,025	79.9%
60-90	759	20.0%
70-100	303	8.0%
90-120	0	0.0%
90-90	3,784	99.9%
90-180	2	0.1%
0-180	3,787	100.0%

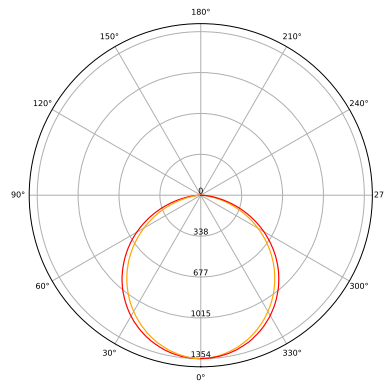

GLI-FCTA-14-SD-V2-3SK-XX-XX 3CCT@3500K		
ZONE	LUMENS	%
0-30	1,042	27.9%
0-40	1,701	45.5%
0-60	2,986	79.9%
60-90	749	20.0%
70-100	299	8.0%
90-120	0	0.0%
90-90	3,735	99.9%
90-180	2	0.1%
0-180	3,737	100.0%

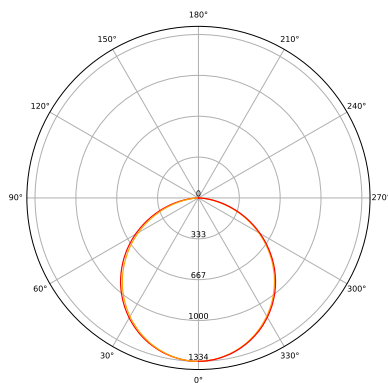

GLI-FCTA-22-SD-V1-3SK-XX-XX 3CCT@3500K		
ZONE	LUMENS	%
0-30	1,031	27.5%
0-40	1,686	45.0%
0-60	2,972	79.3%
60-90	773	20.6%
70-100	315	8.4%
90-120	0	0.0%
90-90	3,745	99.9%
90-180	2	0.1%
0-180	3,747	100.0%

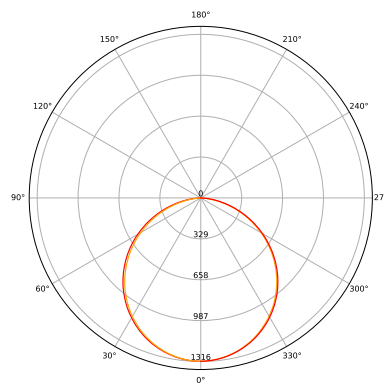

GLI-FCTA-22-SD-V2-3SK-XX-XX 3CCT@3500K		
ZONE	LUMENS	%
0-30	1,016	27.5%
0-40	1,662	45.0%
0-60	2,930	79.3%
60-90	762	20.6%
70-100	310	8.4%
90-120	0	0.0%
90-90	3,692	99.9%
90-180	2	0.1%
0-180	3,694	100.0%

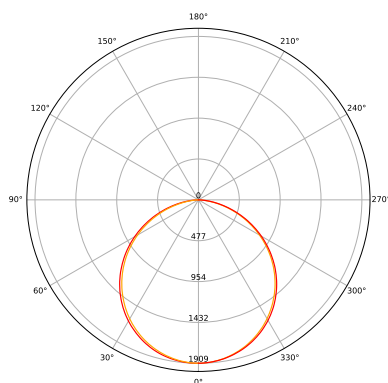

GLI-FCTA-24-SD-V1-3SK-XX-XX 3CCT@3500K.SVG		
ZONE	LUMENS	%
0-30	1,482	27.3%
0-40	2,429	44.8%
0-60	4,293	79.1%
60-90	1,130	20.8%
70-100	464	8.6%
90-120	1	0.0%
90-90	5,423	100.0%
90-180	2	0.0%
0-180	5,425	100.0%

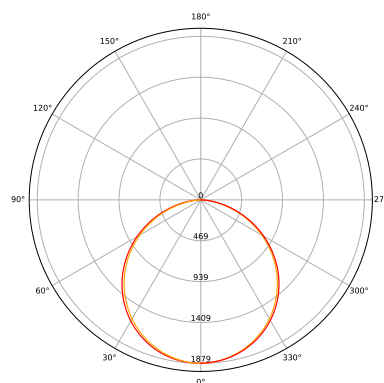

GLI-FCTA-24-SD-V2-3SK-XX-XX 3CCT@3500K		
ZONE	LUMENS	%
0-30	1,458	27.3%
0-40	2,389	44.8%
0-60	4,223	79.1%
60-90	1,111	20.8%
70-100	456	8.6%
90-120	1	0.0%
90-90	5,335	100.0%
90-180	2	0.0%
0-180	5,336	100.0%

PHOTOMETRY

[↗ IES Files](#)

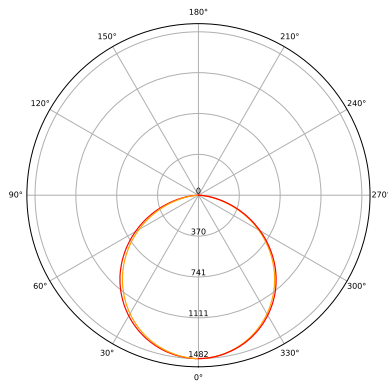

GLI-FCTA-22-PD-V1-3SK-XX-XX 3CCT@3500K		
ZONE	LUMENS	%
0-30	1,147	27.6%
0-40	1,878	45.2%
0-60	3,309	79.7%
60-90	838	20.2%
70-100	334	8.0%
90-120	0	0.0%
0-90	4,147	99.9%
90-180	4	0.1%
0-180	4,151	100.0%

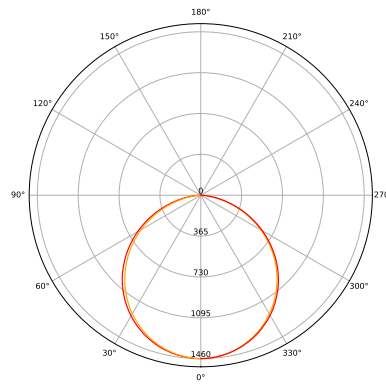

GLI-FCTA-22-PD-V2-3SK-XX-XX 3CCT@3500K		
ZONE	LUMENS	%
0-30	1,130	27.6%
0-40	1,850	45.3%
0-60	3,259	79.7%
60-90	825	20.2%
70-100	329	8.0%
90-120	0	0.0%
0-90	4,085	99.9%
90-180	3	0.1%
0-180	4,088	100.0%

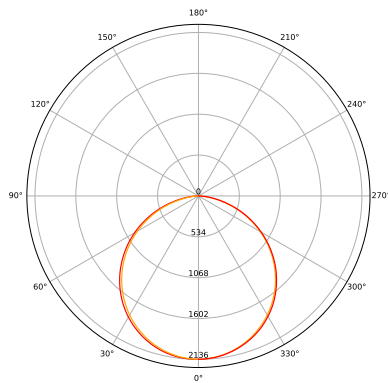

GLI-FCTA-24-PD-V1-3SK-XX-XX 3CCT@3500K		
ZONE	LUMENS	%
0-30	1,659	27.3%
0-40	2,719	44.8%
0-60	4,809	79.2%
60-90	1,256	20.7%
70-100	510	8.4%
90-120	3	0.0%
0-90	6,065	99.9%
90-180	5	0.1%
0-180	6,070	100.0%

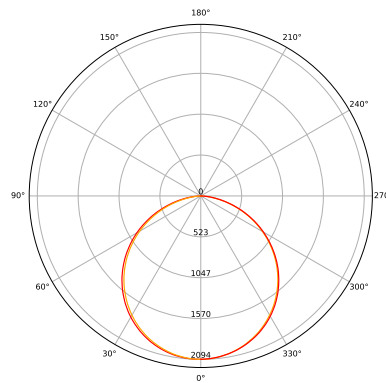

GLI-FCTA-24-PD-V2-3SK-XX-XX 3CCT@3500K		
ZONE	LUMENS	%
0-30	1,626	27.3%
0-40	2,665	44.8%
0-60	4,714	79.2%
60-90	1,231	20.7%
70-100	501	8.4%
90-120	3	0.0%
0-90	5,946	99.9%
90-180	5	0.1%
0-180	5,950	100.0%