

Junction Box Integrated Downlight

GLI-JBIDL

INSTALL AND MAINTENANCE MANUAL

WARNING

1. Read all instructions.
2. Install in accordance with national and local electrical code regulations.
3. This product is intended to be installed and serviced by a qualified, licensed electrician.
4. Turn off electrical power before installing or servicing luminaire in any way.
5. To reduce the risk of fire and overheating, make sure all connections are tight.



**May result in serious injury or death.
Turn power OFF at circuit breaker
prior to installation or servicing.**

Junction Box Integrated Downlight

CAUTION

- Before connecting the light, verify that the input voltage is compatible to prevent damage.
- Carefully check for any signs of damage upon opening the package.
- Before connecting to the power supply, switch off the breaker and verify that it is off to prevent electric shock.
- To prevent damage, avoid exposing wiring to sharp edges or objects.
- Openings in driver box should be made exclusively in factory knockouts.

INSTALLATION INSTRUCTIONS

PRE-INSTALLATION

Before beginning installation, turn OFF power from the electrical panel.

STEP 1

If the LED engine and trim are not together, combine them. (Fig. 1)

STEP 2

Turn clockwise until it is tight (Fig. 2)

Fig. 1

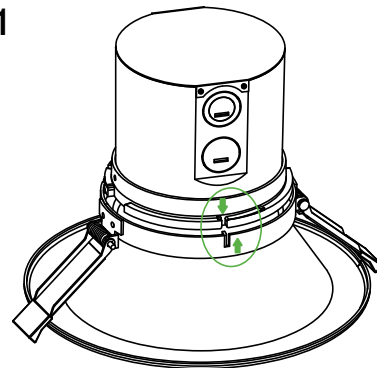
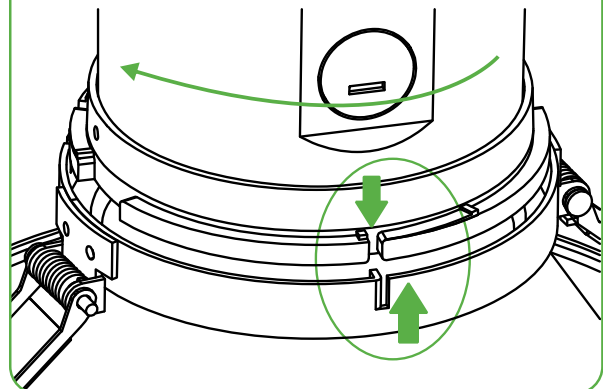
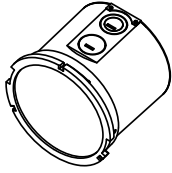

Fig. 2



Junction Box Integrated Downlight

OPTIONAL LED ENGINES



10W/15W/20W

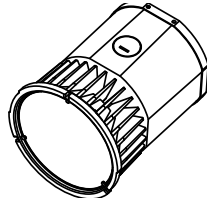

20W/40W

OPTIONAL TRIMS

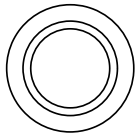

4" Round

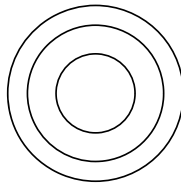

6" Round

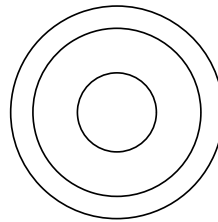

8" Round

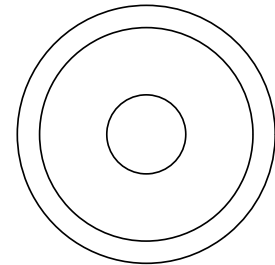

10" Round

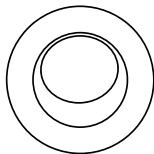

4" Round Wall Wash

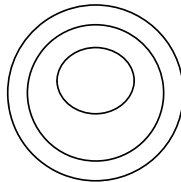

6" Round Wall Wash

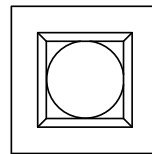

4" Square

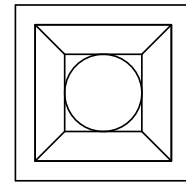

6" Square

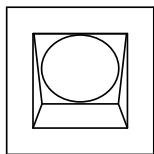

4" Square Wall Wash

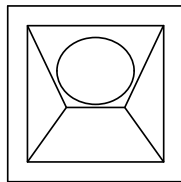

6" Square Wall Wash

Junction Box Integrated Downlight

INSTALLATION INSTRUCTIONS

INSTALLATION

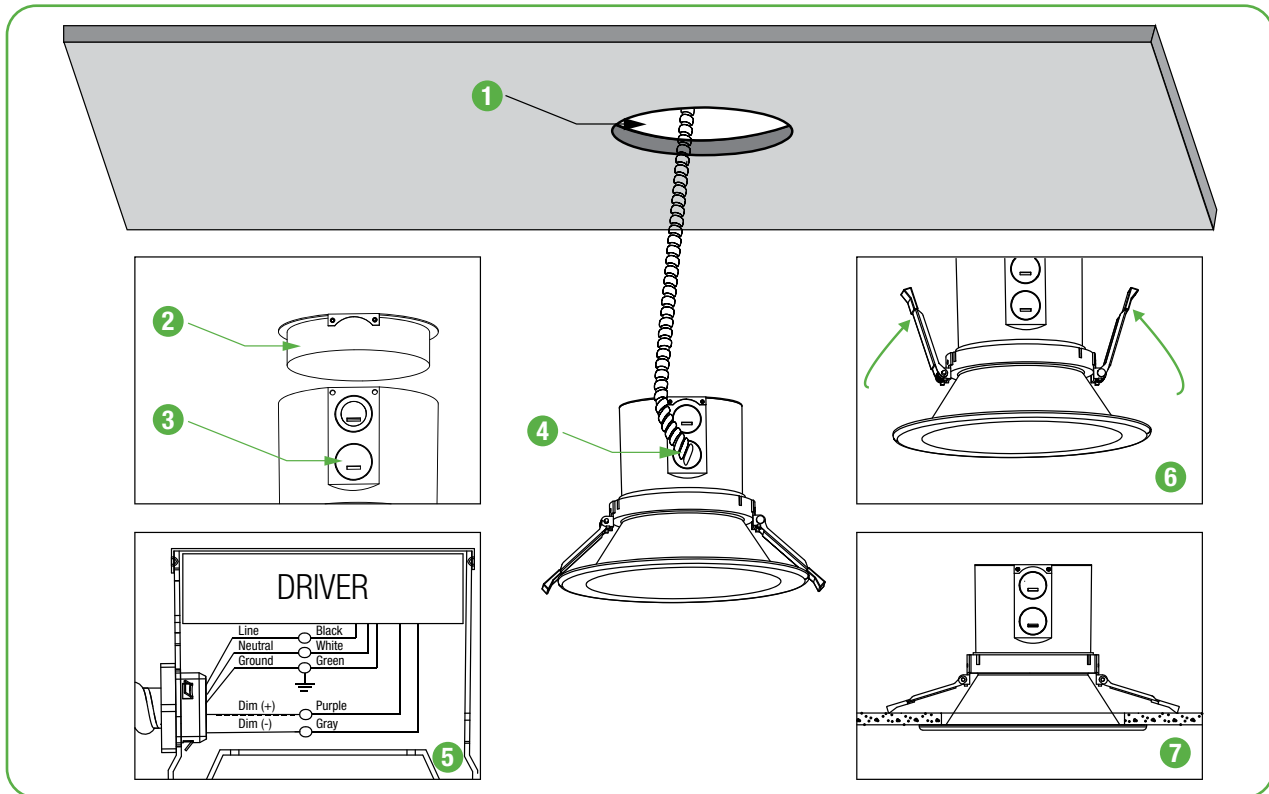

STEP 1

Drill a hole into the ceiling according to the recommended trim size (See Table 1)

STEP 2

Follow the arrow directions and open the LED cover.

STEP 3

Remove appropriate knockout(s) for power supply wiring.

STEP 4

Use a conduit fitting to put power supply wires into the junction box.

Table 1

TRIM TYPE	RECOMMENDED HOLE SIZE
4 inch round	4.7" min. to 5.2" max.
4 inch round wall wash	5.3" min. to 6" max.
4 inch square	5.3" min. to 6" max.
4 inch square wall wash	5.3" min. to 6" max.
6 inch round	6" min. to 7.3" max.
6 inch round wall wash	6" min. to 7.3" max.
6 inch square	6" min. to 7.3" max.
6 inch square wall wash	6" min. to 7.3" max.
8 inch round	7.4" min. to 8.9" max.
10 inch round	9.5" min. to 10.8" max.

Junction Box Integrated Downlight

INSTALLATION INSTRUCTIONS

STEP 5

Connect the line to the black wire, neutral to the white wire and ground wire to the green wire with the supplied quick disconnect.

NOTE: Compatible with 0-10V dimmer If need dimming. The driver PUR(D+) to the dimmer+(PUR), and the driver GRY(D-) to the dimmer-(GRY) with the supplied nuts.

Tuck all wires and wire nuts into the fixture junction box.

Follow the arrow directions and close the LED cover.

STEP 6

Mount the LED Downlight onto the ceiling by tightening the spring. Adjust the position and complete installation .

OPTIONAL FUNCTION:

Use the wattage and CCT dip-switch (if equipped) to adjust the fixture to the desired wattage level and CCT. Refer to label on top of driver for each setting.