

# Wall Pack Light B

## GLI-WPLB

### INSTALL AND MAINTENANCE MANUAL

#### WARNING

1. Read all instructions.
2. Install in accordance with national and local electrical code regulations.
3. This product is intended to be installed and serviced by a qualified, licensed electrician.
4. Turn off electrical power before installing or servicing luminaire in any way.
5. To reduce the risk of fire and overheating, make sure all connections are tight.



**May result in serious injury or death.  
Turn power OFF at circuit breaker  
prior to installation or servicing.**

### WARNINGS AND CAUTIONS

- **Electrical Safety:** Disconnect power at the circuit breaker before installation or maintenance to avoid electric shock.
- **Qualified Personnel:** Installation must be performed by a licensed electrician in compliance with local codes.
- **Voltage Verification:** Ensure the supply voltage matches the fixture's specifications to prevent damage.
- **Secure Mounting:** Verify that the mounting surface or structure can support the weight of the fixture.
- **Wiring Precautions:** Ensure all wiring connections are properly insulated and secure to prevent hazards.
- **Environmental Conditions:** Suitable for both indoor and outdoor use. Ensure the installation environment is free corrosive substances.
- **Avoid Exposure:** Do not install the fixture in areas prone to prolonged submersion or extreme environmental conditions unless specifically rated for such use.
- **Apply Caulking:** Caulk the top and sides of the fixture where it meets the wall with weather-resistant sealant. Leave the bottom uncaulked for drainage.

# GLI-WPLB Wall Pack Light B Installation Instructions

## PROCEDURE

### MOUNTING

1. Remove the screw securing the fixture body to the fixture base.
2. Swing the fixture body open.
3. Choose the appropriate mounting holes on the fixture base based on wall or junction box installation. Drill or knock them out as needed.
4. If mounting on a wall, drill matching holes and install anchors as required.
5. Secure the fixture base to the electrical junction box or directly to the wall.

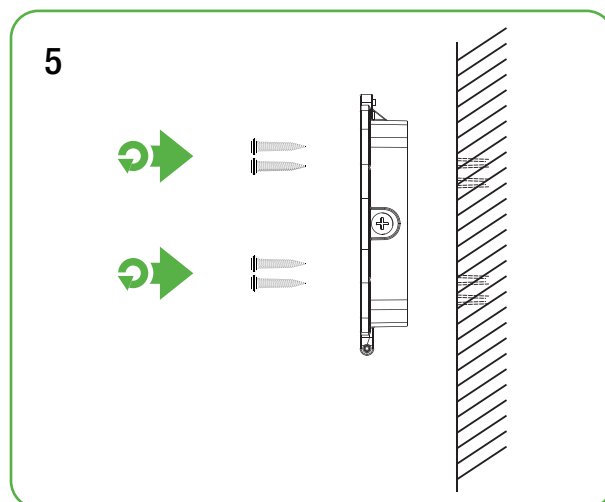
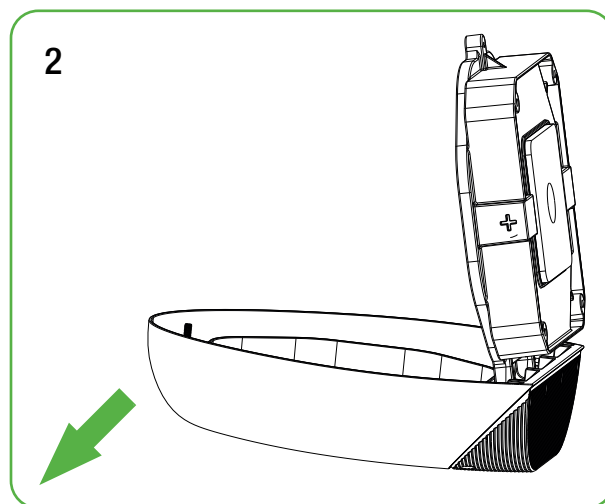
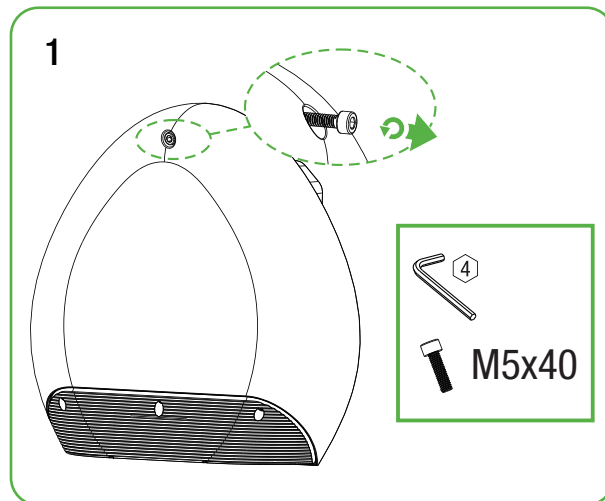

## GLI-WPLB Wall Pack Light B Installation Instructions

6. Hinge the fixture body back onto the fixture base.
7. Remove the threaded plug as needed for wiring entry, depending on the installation method.
8. Bring the electrical wiring into the fixture through a threaded entry using a waterproof connector or gland.

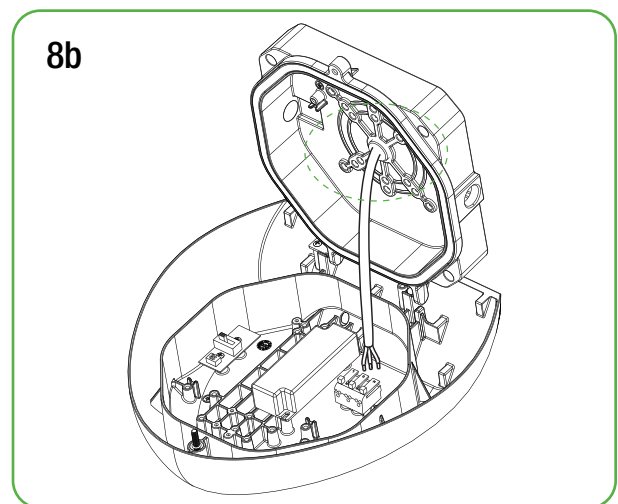
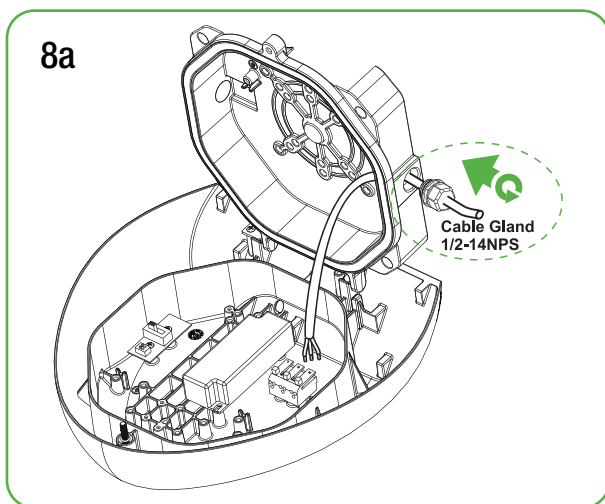
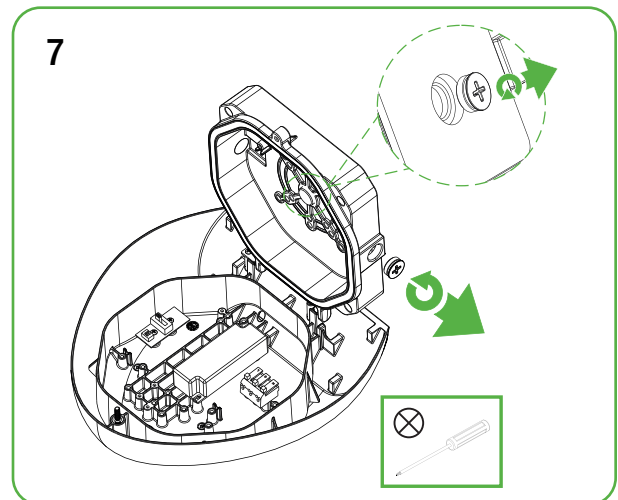
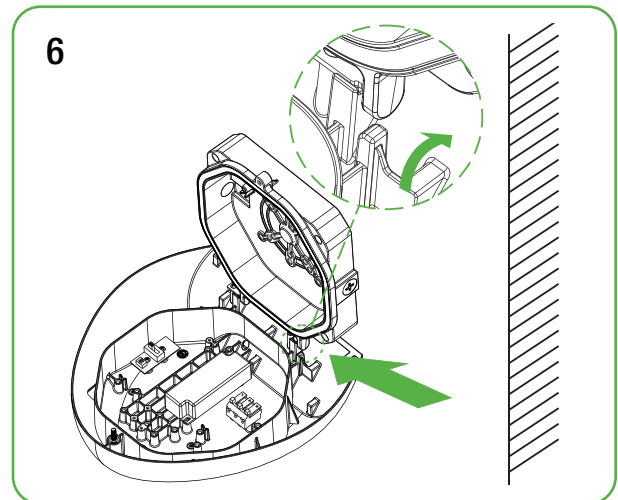

## GLI-WPLB Wall Pack Light B Installation Instructions

9. Connect the wires to the terminals according to the following:
  - **Black:** Live/Hot
  - **White:** Neutral
  - **Green:** Ground
  - **Purple:** Dim+ (if applicable)
  - **Pink:** Dim- (if applicable)
10. If not using dimming, individually cap the dimming wires with wire nuts or approved connectors.
11. (OPTIONAL) If equipped, CCT or Wattage switches can be adjusted before closing the fixture
12. Ensure all connections are properly insulated and tuck them neatly into the junction box.
13. Swing the fixture body onto the fixture base and tighten the screw to secure it in place.
14. Caulk the top and sides of the fixture where it meets the wall with weather-resistant sealant. Leave the bottom uncaulked for drainage.

